

TOWER STEEL, LLC

“Stair Tower Module System”
(Patent Pending – All Rights Reserved)

System Benefits

Efficient

- Stair towers allow authorized personnel the quickest way to ascend and descend tall towers with climb rates up to 60 feet per minute or more.
- Stair towers allow numerous authorized personnel to utilize the system at the same time while moving in both directions at the same time.

Accessible

- Stair towers dramatically expand the demographic of people able to access the nacelle.
- Stair towers provide ready access to first responders for medical emergencies and fire fighting.

Economical

- Stair towers do not require training, certification, regular maintenance, special physical capabilities or electricity.
- Stair towers allow workers to accomplish tasks in less time reducing tower construction cost and future farm operating cost providing short term and long term returns on investment.

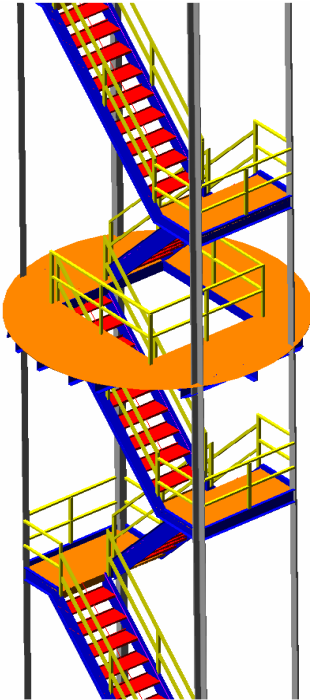

Life Safety

- Stair towers do not require fall arrest devices, as long as authorized personnel stay on the walking surface they are within the guardrail system.
- Stair towers are generally accepted as the best way to evacuate people from tall structures in the case of fire or other emergency exit conditions.

Versatility

- Stair towers are suitable for land based and offshore wind farm applications.
- Stair towers are offered in several styles, materials types and finishes to almost any length with optional integrated work platforms available.

